

Doing
it Right...



Steel security cables provided with SCOREMASTER goals can be used in conjunction with concrete footings, steel augers or steel spikes permanently embedded in the field. This is the best solution to safety and security concerns. Use a system that suits your application and field conditions.



Anchoring

Soft field conditions or permanent installations require permanent anchors as prescribed above. Z/Spike anchors provide a quick and reliable method of tethering goals in firm ground conditions.

1. Insert Z/Spike into ground beside the intersection of the rear cross bar and the net rack as shown in the photograph.
2. Make sure that the anchor is firmly planted in the ground by pulling up and forward on the ring.
3. Install the safety strap around the net rack and through the eye of the Z/Spike.



Security Cables can be used with permanent anchors to secure goals



Z/Spikes are fast, easy to use, temporary method of securing goals.



SCOREMASTER

Security & Safety

Safety Rules



- Never allow anyone to climb, swing or hang from goal frames or netting.
- Remove nets when goals are not in use.
- Moveable Goals should be anchored at all times using either goal spikes or permanent ground sleeves.
- Goals that are secured using only ground spikes should be locked or chained together when not in use. Goals can also be chained to nearby fence or any permanent structures in a well lit area.
- Use net hardware that does not have sharp edges or protrusions which could injure players. Check all connecting hardware before every use. Replace damaged or missing fasteners immediately.
- Fully disassemble goals for seasonal storage.
- Always use extreme caution when moving goals (see detailed section on moving soccer goals). Always instruct players on handling safety and the potential dangers associated with moveable soccer goals.
- Use moveable soccer goals only on level (flat) fields.
- Ensure safety labels are clearly visible.
- Always use adequately trained personnel when moving goals or installing nets.
- Only use goals that are correctly engineered from a reputable source.

ALL PERSONS USING GOALS MUST BE FAMILIAR WITH AND FOLLOW THESE RULES AT ALL TIMES.

SCOREMASTER

Maintenance & Handling

Maintenance

Bare aluminum goals can be cleaned with any commercial aluminum cleaner or with readily available automotive aluminum wheel cleaner and a garden hose. To remove scratches use a medium grade Scotch Brite Pad. **DO NOT USE STEEL WOOL.**

Painted goals have a powder coat finish, which can be maintained in the same manner you would care for your automobile's finish. Protect it from scratches from sharp objects and wash with any car wash product and wax if desired. SoftScub bathroom cleaner works great to remove scuffs and stains.

Inspect goals for loose fasteners or damage and report any problems at once to your administrators.

Handling

1. Never tow, push or pick up the goals with any vehicle, tractor, mower or construction equipment. Damage caused by moving goals with equipment will not be covered under warranty.
2. Never drop the goals on each other or allow them to crash together. This could dent the material or cause weld fractures.
3. Always exercise extreme caution when moving goals and allow adequate manpower for goals of varied sizes and weights.
4. The base materials of the Scoremaster goals are designed to slide over most surfaces without snagging the surface. Goals should be moved by pushing on the uprights. Two persons are generally required for this task, although one person can move a goal a sufficient distance for field maintenance.

Trouble Shooting

Problem - Cross bars will not slide over goal end stubs.

Cause - Galled or dented tubing.

Solution - Sand or file burrs or galling from the cross bar and the goal end stub. Clean and lubricate after sanding.

Care should always be taken not to damage goal intersections while being assembled and disassembled.

Problem - Goal ends will not slide over goal end stubs.

Cause - Misalignment of goal ends to cross bars.

Solution - Make sure crossbars are parallel and 90 degrees to the goal ends. Start both front and rear crossbars at the same time and slowly advance the stubs together. Use a stepladder on larger goals to make work easier.

Problem - Bolts are difficult to tighten.

Cause - Threads are either dry or cross threaded.

Solution - Back the bolt out of the hole, lubricate with light oil or an anti seizing compound and carefully reinstall. Run a 3/8" NC tap through the hole if necessary.

Care should be taken not to cross thread or over tighten assembly bolts.



Net Installation.

1. Stand on a ladder or step stool and attach the upper corner of the net to the upper corner of the cross bar and work your way to the opposite corner. Tuck the net perimeter rope or the net twine under the net fasteners.
2. Tighten the net line (see above) between the top bend on the net racks to keep the net from sagging in the center.
3. Attach the edge of the net to the goal uprights and rear crossbar.

SCOREMASTER

Assembly Instructions



D/Max Moveable Goals

Check your order for damaged or missing parts & report any irregularities to the freight company and SCOREMASTER at once at 1-888-726-7627. Make sure you have your order number.

This product sheet must be reviewed by all coaches, managers, players, grounds keepers and personnel involved in the use of these products.

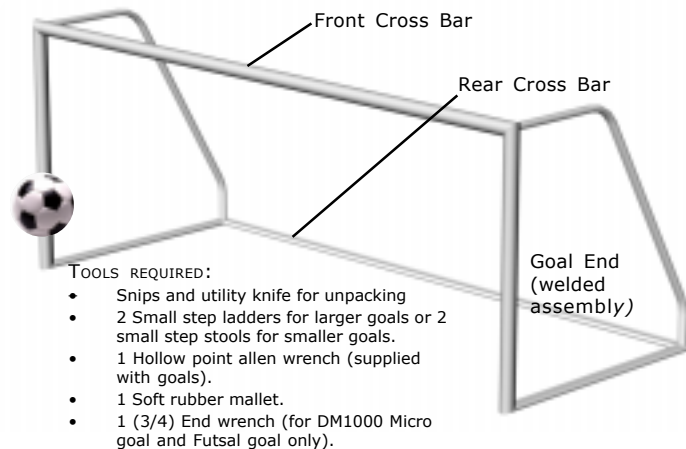

Assembly time is 15-30 minutes the first time. Three persons are recommended to assemble the 1600-2400 goals and two persons are needed to assemble the 1000-1200 Micro and Futsal goals. Follow the instructions and do not force parts together.



A. Goal end stub

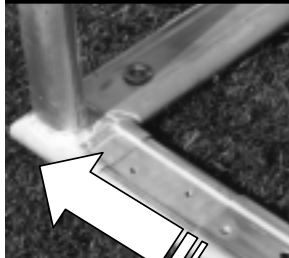

B. Goal end stub and rear cross bar intersection.



C. Slide front cross bar on straight and square.

1. Lay the goal sections for each goal end on a large **flat** surface that will not scratch the finish.

2. IMPORTANT! The inside of the front and rear crossbar ends are pre-lubricated at the factory with white grease. If there is no lubricant present, lubricate with grease.

3. Remove the stainless steel bolts from the stubs on the goal ends. See A.

4. Stand the first goal end upright & slip the rear cross bar on the stub end. See B.

WARNING - Do not force goal parts together. Make sure they are aligned properly and use gentle taps with a rubber hammer if required.



D. Slide front cross bar and rear cross bar on at the same time and straight or the goal will not fit together.



E. Bolt it up!

5. Support one end of the front cross bar with a ladder or have someone hold it and install the other end over the upper goal end stub. See C.

6. Now the other side. Erect the other goal end and simultaneously slide both front and rear cross bars over the goal end stubs as far as they will go. Tap them together if necessary. See D.

IMPORTANT - Make sure that both cross bars are slid into the goal end stubs the same time and that they are square to each other.

7. Install the assembly screws into the upper and lower cross bars and final tighten all of the screws with the wrench provided. See E. Check all bolts again when your are done.

Micro and Futsal Goals



1. Read the instructions for the D/Max Movable goals. It is best to lay the goal ends face down to begin assembly. This is different than the larger goals.

2. Slide the front cross bar onto the stubs on the goal uprights and the rear cross bar tie bolt into the net rack as shown in the photo to the right.



3. Install the cross bar hardware as shown on the right.

Micro, Futsal and Permanent Goals share the same assembly stubs as the D/max Moveable goals. Please refer to the appropriate instructions on the other leaf for installation of the cross bars. Call Scoremaster if you are having problems - we are always here with support.

All Scoremaster products carry a 5 year Warranty. Your product is shipped with a Warranty Claim Form that describes our Warranty Policy and tells you how to make a claim in the unlikely event that you would need to. All repairs and warranty claims are handled promptly "Scoremaster never misses a game."

Customer Service

If you have any
problems or questions please
call us at
1-888-726-7627
or log onto our website at
www.scoremaster.com

Service Beyond Service

P/Series Permanent Goals

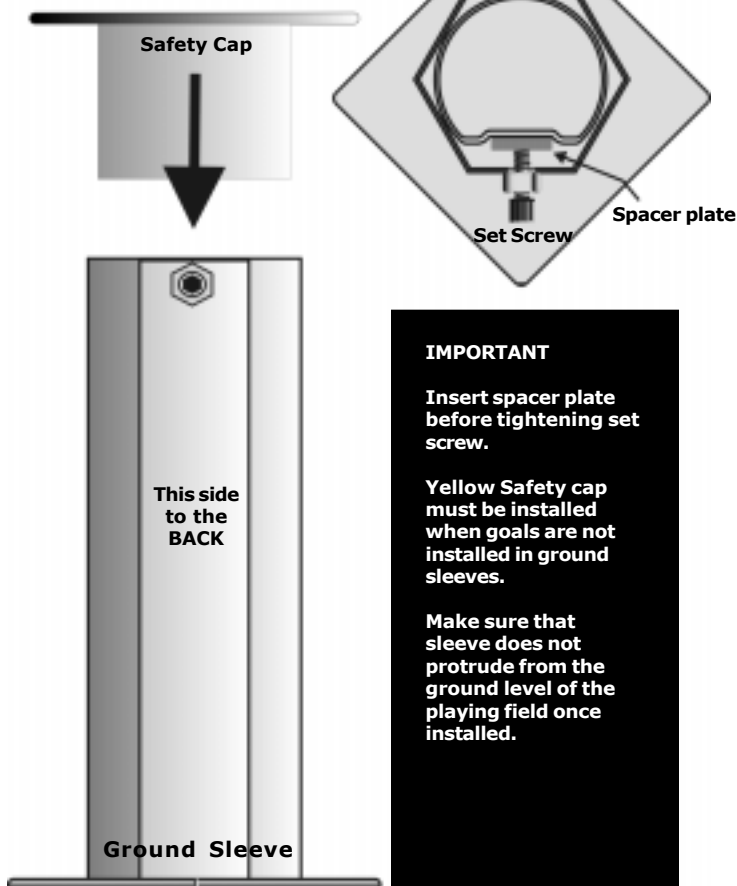

1. The method of excavating for the ground sleeves will vary according to ground conditions and available equipment. Consult your grounds maintenance department or local contractor to establish the most efficient way of burying the sleeves.

2. Place the ground sleeves in the excavation and check to make sure that they are plumb and square. The center to center distance of the holes should match the goal. Do not install the ground sleeves proud of the field surface. This will create a safety hazard. Leave the sleeves loose enough in the excavation to be adjusted.

3. Lay the goal parts out flat and assemble the ends as per the **D/Max Moveable** instructions. Do not tighten the assembly screws until the goals have been installed in the ground sleeves.

4. Install the goal into the ground sleeves.

5. Tighten the assembly screws on the goal cross bar.

6. Install the spacer plate between the set screw and the back of the goal and tighten the set screw.

7. Fill in the excavation around the ground sleeve with soil or concrete.